

1/4 SIZE DETAILS

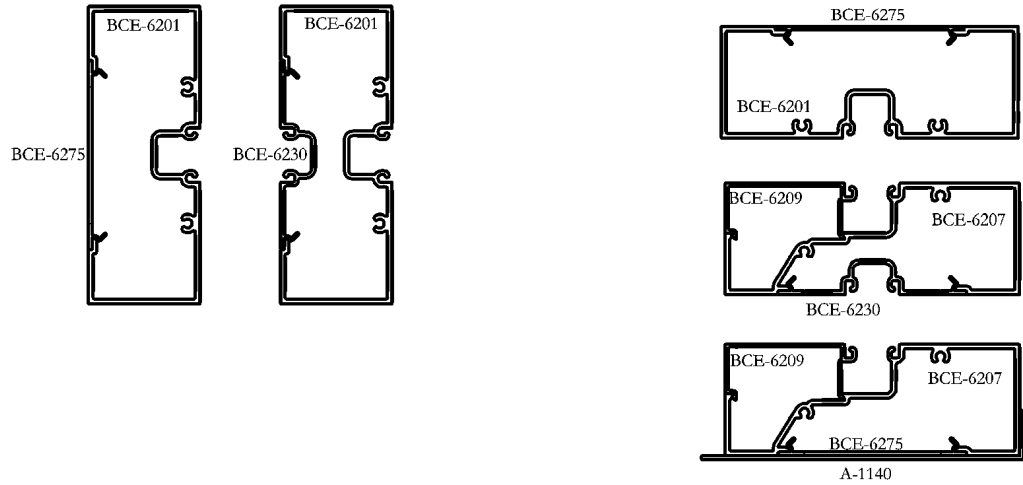

THIS SYSTEM IS DESIGNED TO BE ASSEMBLED WITH #12 SELF TAPPING SCREWS.

GASKET INFORMATION

REED RUBBER PRODUCTS

PH.# 800-325-9698

3734

INTERIOR & EXTERIOR GASKET

#4893

ALTERNATIVE

UNIVERSAL RUBBER COMPANY

PH.#800-782-2375

2028

INTERIOR & EXTERIOR GASKET

TREMCO

PH.# 800-321-6357

TR-2062E

INTERIOR & EXTERIOR GASKET

NO TEST DATA AVAILABLE

TREDEGAR EXTRUSIONS INC. DOES NOT MAKE ANY WARRANTY EXPRESS OR IMPLIED INCLUDING NO WARRANTY OF MERCHANTABILITY OR FITNESS FOR A PARTICULAR PURPOSE AND RESERVES THE RIGHT TO MAKE CHANGES
 REPRODUCTION RIGHTS RESERVED

PRICING FACTORS
2 1/4" X 6" FLUSH GLAZED
BCE-6200 SERIES



WEIGHT PER FT	EST PER	FACTOR	CAVITY AREA	PART NUMBER	STRUCTURAL VALUES			1/8 SIZE DETAILS
					X-X		Y-Y	
1.769	32.013	18	N/A	BCE6201	1.001	I	6.539	
					0.688	S	2.180	
1.541	26.870	17	N/A	BCE6207	0.806	I	5.246	
					0.714	S	1.568	
0.400	10.441	26	N/A	BCE6209	0.041	I	0.325	
					0.050	S	0.245	
0.556	12.318	22	N/A	BCE6230	0.023	I	0.483	
					0.048	S	0.253	
0.398	9.097	23	N/A	BCE6275	0.001	I	0.454	
					0.003	S	0.238	
0.694	14.949	22	N/A	A1140	0.021	I	2.429	
					0.023	S	0.666	

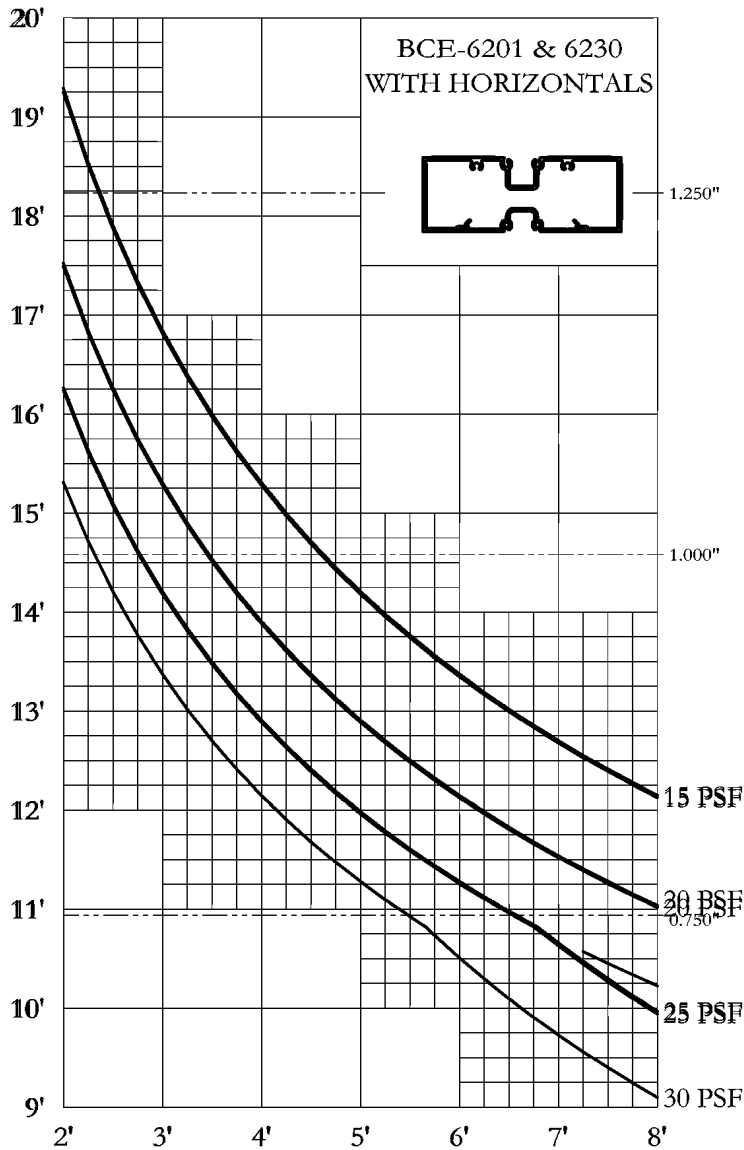

#1 THESE WINDLOAD CHARTS ARE BASED UPON THE LESSER OF DEFLECTION RATIO (L/175) OR STRESS (12667)

#2 THESE STRUCTURAL CURVES ARE ESTIMATES AND ARE PRESENTED TO THE BEST KNOWLEDGE OF THE WILLIAM L BONNELL CO. IT IS, HOWEVER, THE RESPONSIBILITY OF THE CUSTOMER TO BE SATISFIED THAT THE CURVES ARE CORRECT. THE WILLIAM L BONNELL CO. MAY NOT BE HELD RESPONSIBLE IN ANY WAY FOR THE FAILURE OF PERFORMANCE RESULTING FROM THE USE OF THESE CURVES.

DETAIL SHEET
2 1/4" X 6" FLUSH GLAZED
BCE-6200

FULL SIZE DETAILS

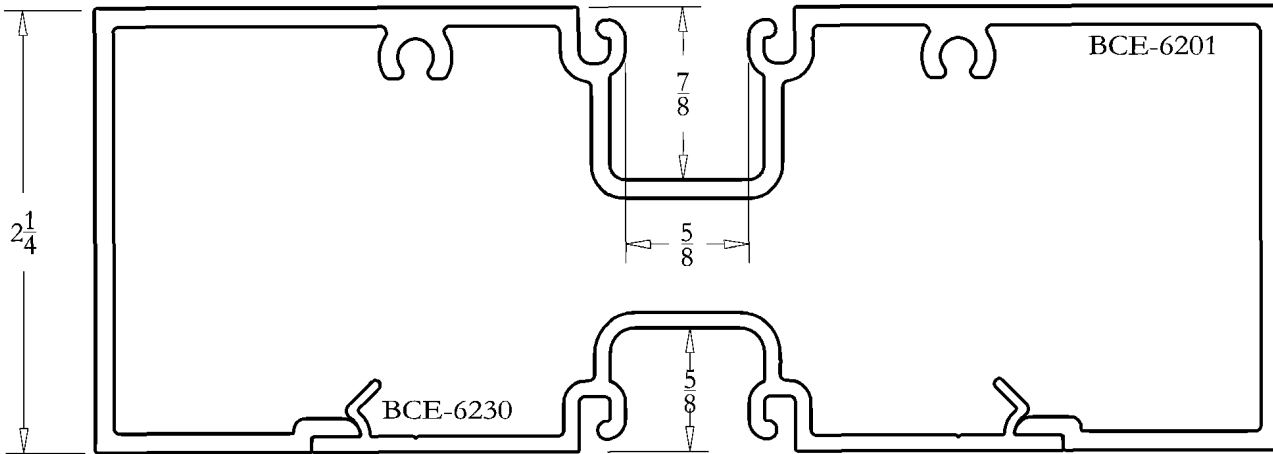
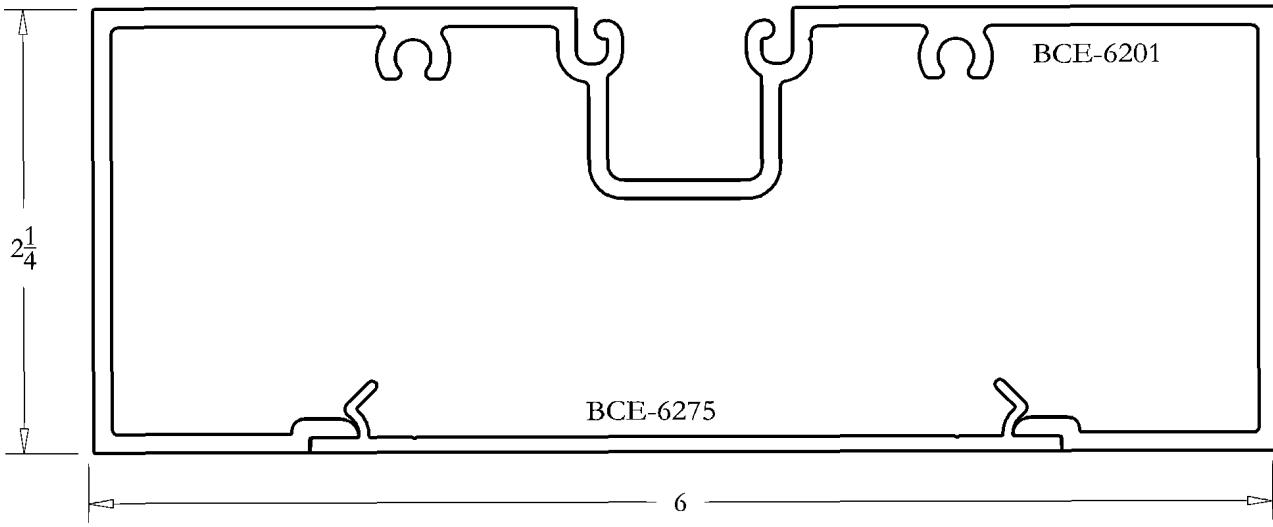

FULL SIZE DETAILS

