

1/4 SIZE DETAILS

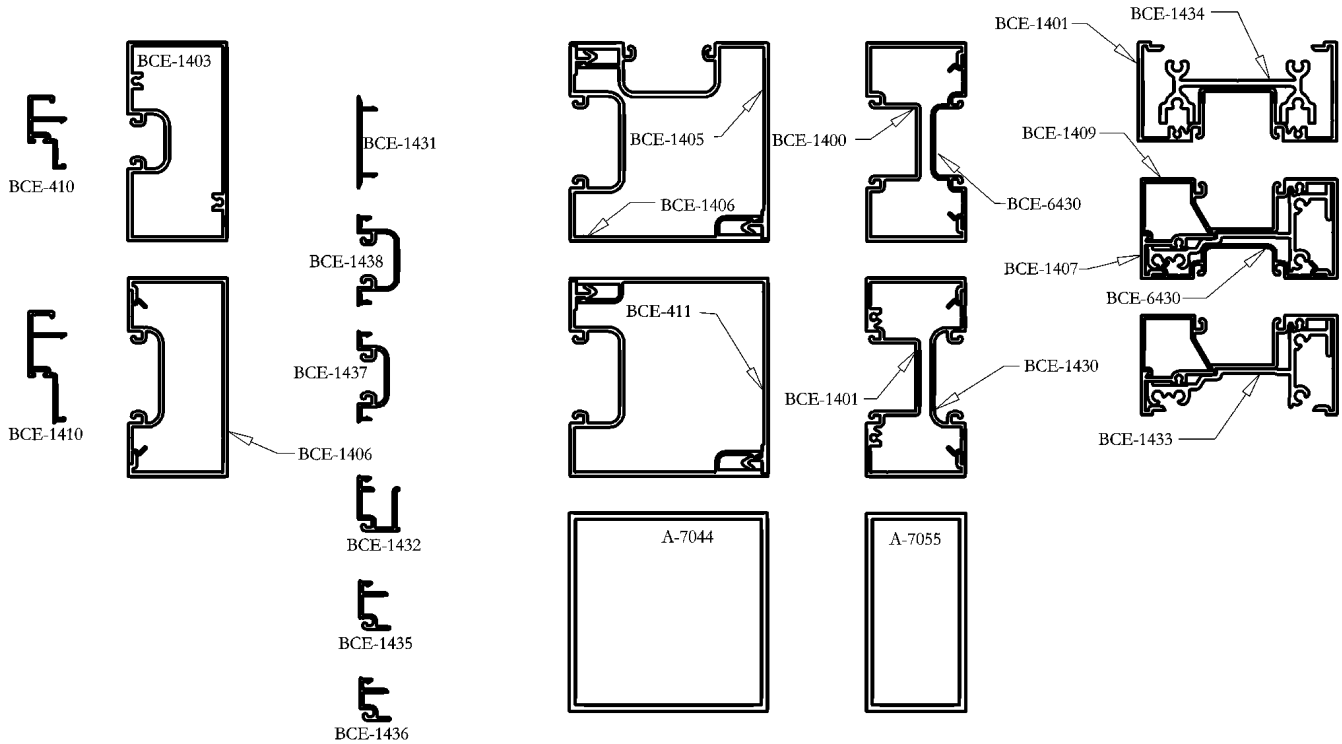

THIS SYSTEM IS DESIGNED TO BE ASSEMBLED WITH #8 SCREWS

GASKETS

UNIVERSAL RUBBER CO. 800-782-2375	#2028 #2090	INTERIOR & EXTERIOR 5/8" GLASS IN 1 3/8" POCKET
REED RUBBER PRODUCTS 800-325-9698	#3734 #4893	INTERIOR & EXTERIOR ALTERNATIVE
TREMCO 800-321-6357	TR-2062E	INTERIOR & EXTERIOR

DOOR PILE

SCHLEGEL CORP. 800-828-6237	AS SELECTED	USED WITH BCE-1410 AND LIKE SHAPES
AMESBURY GROUP INC. 704-878-6892	AS SELECTED	USED WITH BCE-1410 AND LIKE SHAPES

NO TEST DATA AVAILABLE  
TREDEGAR EXTRUSIONS INC. DOES NOT MAKE ANY WARRANTY EXPRESS OR IMPLIED INCLUDING  
NO WARRANTY OF MERCHANTABILITY OR FITNESS FOR A PARTICULAR PURPOSE AND RESERVES  
THE RIGHT TO MAKE CHANGES  
REPRODUCTION RIGHTS RESERVED

PRICING FACTORS  
2" X 4" FLUSH GLAZED  
BCE-1400 SERIES

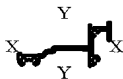
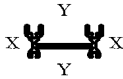
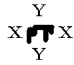
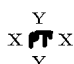
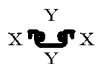
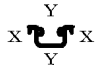
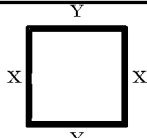
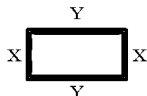
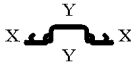

WEIGHT PER FT	EST PER	FACTOR	CAVITY AREA	PART NUMBER	STRUCTURAL VALUES			1/8 SIZE DETAILS
					X-X	Y-Y		
1.115	22.371	20	N/A	BCE1400	0.373	I	2.096	
					0.309	S	1.048	
1.228	23.477	19	N/A	BCE1401	0.407	I	2.234	
					0.322	S	1.117	
1.474	15.036	20	N/A	BCE1403	0.748	I	2.171	
					0.696	S	1.084	
1.308	24.040	18	N/A	BCE1405	1.580	I	1.937	
					0.568	S	0.735	
1.336	24.753	19	N/A	BCE1406	1.989	I	1.630	
					0.759	S	0.587	
0.930	19.003	20	N/A	BCE1407	0.289	I	1.531	
					0.283	S	0.671	
0.308	8.091	26	N/A	BCE1409	0.037	I	0.069	
					0.046	S	0.087	
0.308	8.644	28	N/A	BCE1410	0.013	I	0.112	
					0.029	S	0.087	
0.251	7.076	28	N/A	BCE410	0.010	I	0.037	
					0.022	S	0.045	
1.056	19.485	18	N/A	BCE411	1.665	I	1.696	
					0.595	S	0.615	
0.947	17.611	19	N/A	BCE1412	0.423	I	2.048	
					0.321	S	1.024	
0.552	12.246	22	N/A	BCE1430	0.030	I	0.473	
					0.080	S	0.270	
0.163	4.938	30	N/A	BCE1431	0.001	I	0.040	
					0.003	S	0.043	
0.254	6.731	27	N/A	BCE1432	0.018	I	0.026	
					0.037	S	0.039	

WEIGHT PER FT	EST PER	FACTOR	CAVITY AREA	PART NUMBER	STRUCTURAL VALUES			1/8 SIZE DETAILS
					X-X	I	Y-Y	
0.961	15.078	16	N/A	BCE1433	0.175	I	1.144	
					0.169	S	0.544	
1.116	14.838	13	N/A	BCE1434	0.097	I	1.105	
					0.146	S	0.707	
0.184	4.838	26	N/A	BCE1435	0.004	I	0.016	
					0.010	S	0.029	
0.174	4.575	26	N/A	BCE1436	0.004	I	0.011	
					0.010	S	0.022	
0.310	8.030	26	N/A	BCE1437	0.010	I	0.073	
					0.032	S	0.080	
0.340	8.900	26	N/A	BCE1438	0.022	I	0.081	
					0.050	S	0.089	
2.324	15.988	13	N/A	A7044	4.854	I	4.854	
					2.427	S	2.427	
1.726	12.000	13	N/A	A7055	0.992	I	2.976	
					0.992	S	1.488	
0.425	11.493	27	N/A	BCE6430	0.021	I	0.366	
					0.053	S	0.209	

WINDLOAD CHARTS  
2" X 4" FLUSH GLAZED  
BCE-1400 SERIES

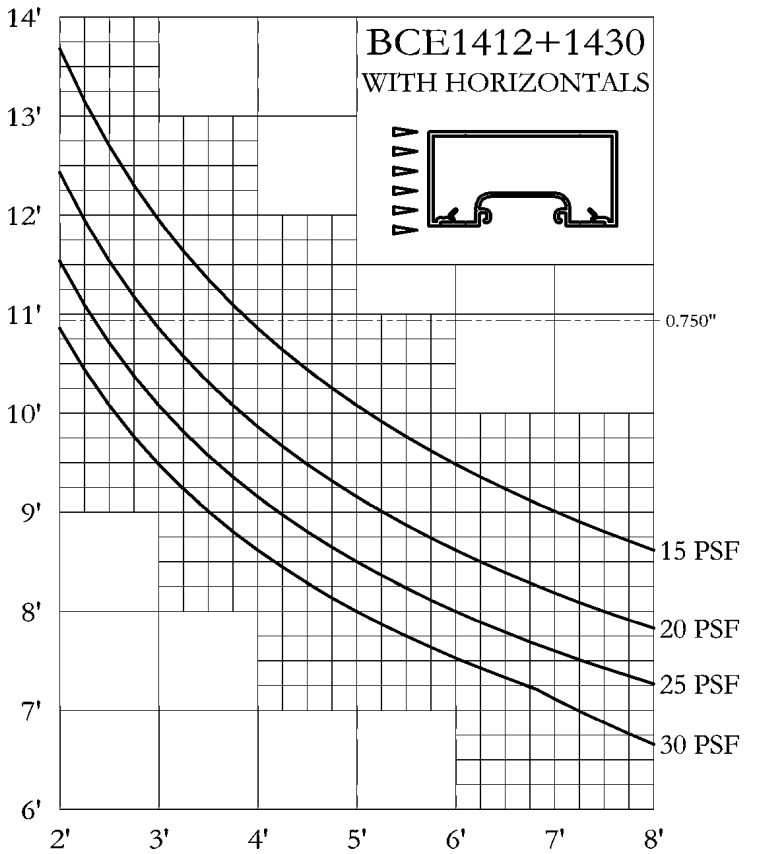
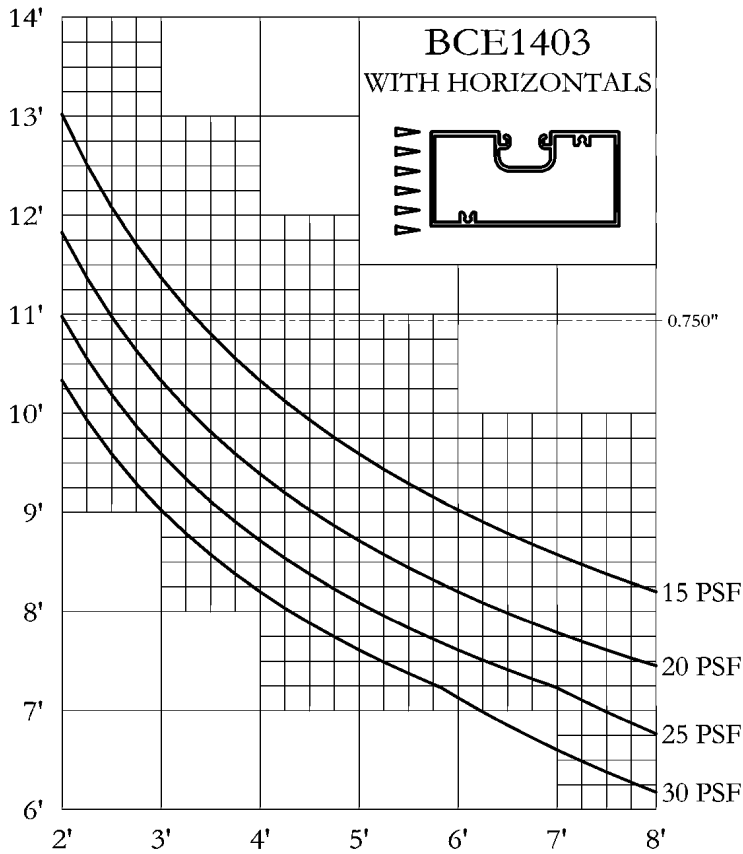
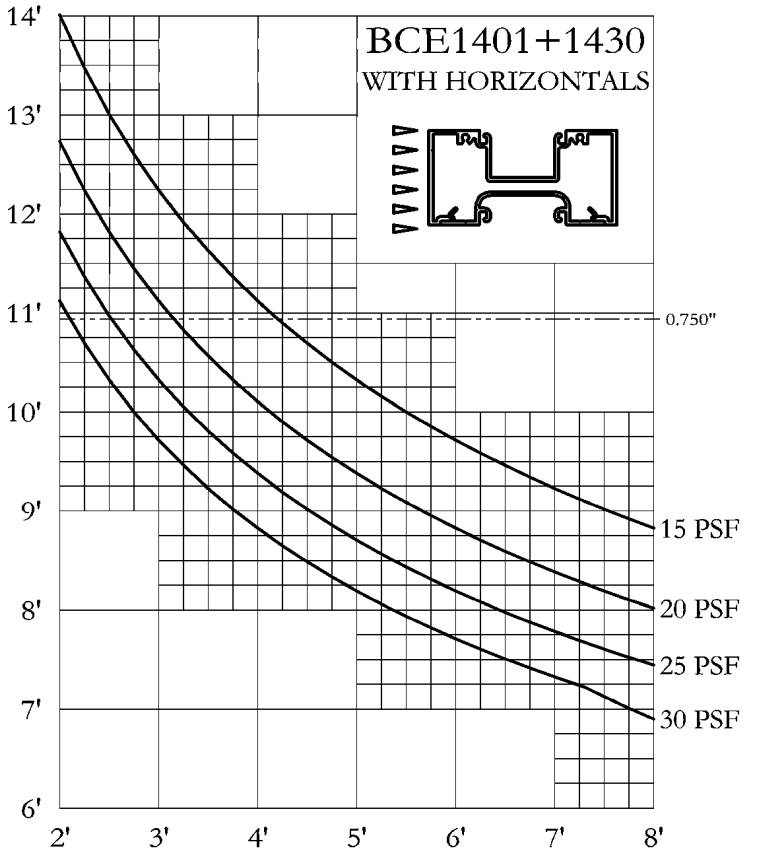
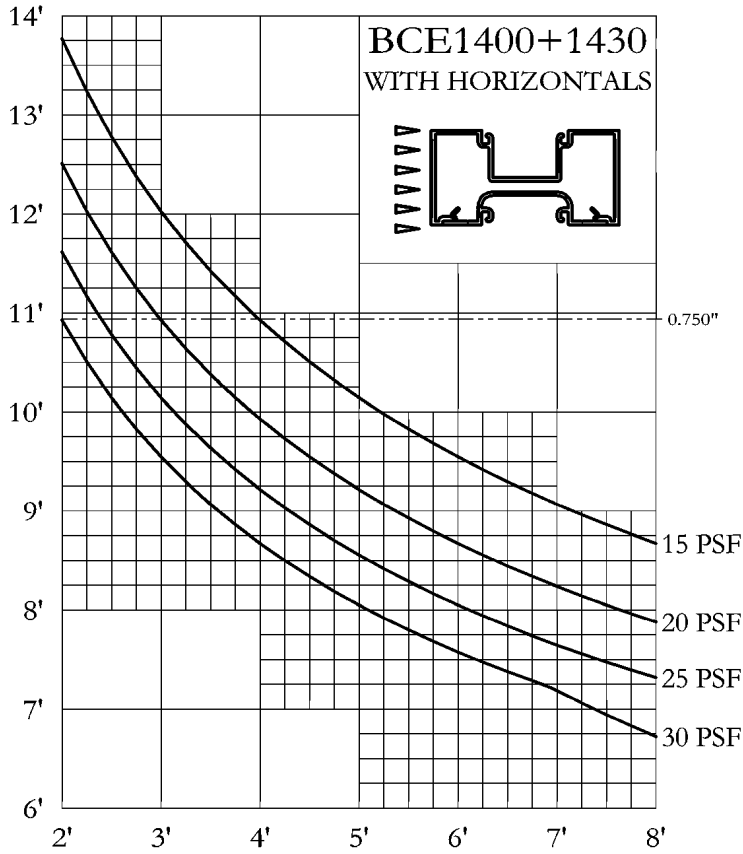

#1 THESE WINDLOAD CHARTS ARE BASED UPON THE LESSER OF DEFLECTION RATIO (L/175) OR STRESS (12667)

#2 THESE STRUCTURAL CURVES ARE ESTIMATES AND ARE PRESENTED TO THE BEST KNOWLEDGE OF THE WILLIAM L BONNELL CO. IT IS, HOWEVER, THE RESPONSIBILITY OF THE CUSTOMER TO BE SATISFIED THAT THE CURVES ARE CORRECT. THE WILLIAM L BONNELL CO. MAY NOT BE HELD RESPONSIBLE IN ANY WAY FOR THE FAILURE OF PERFORMANCE RESULTING FROM THE USE OF THESE CURVES.

FULL SIZE DETAILS

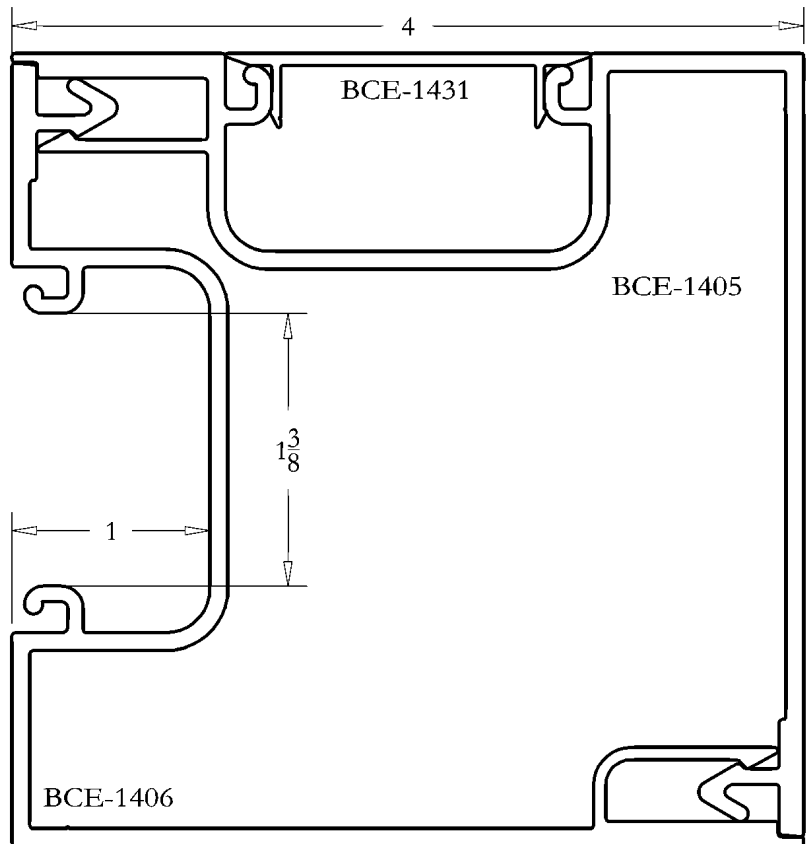
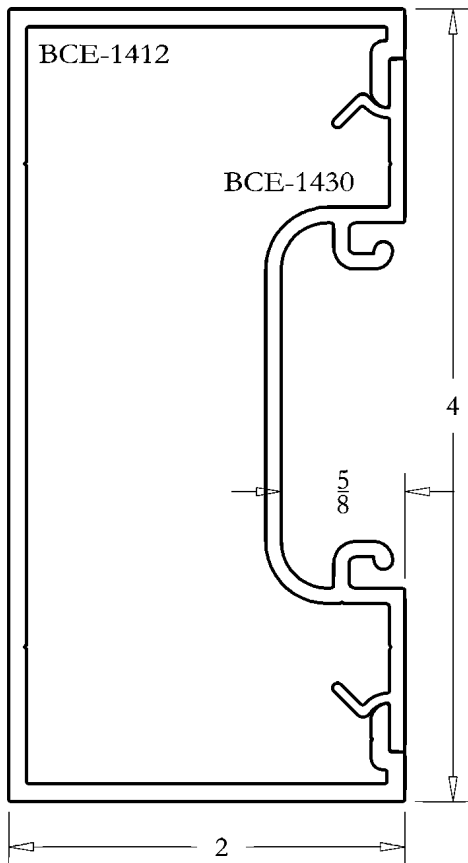
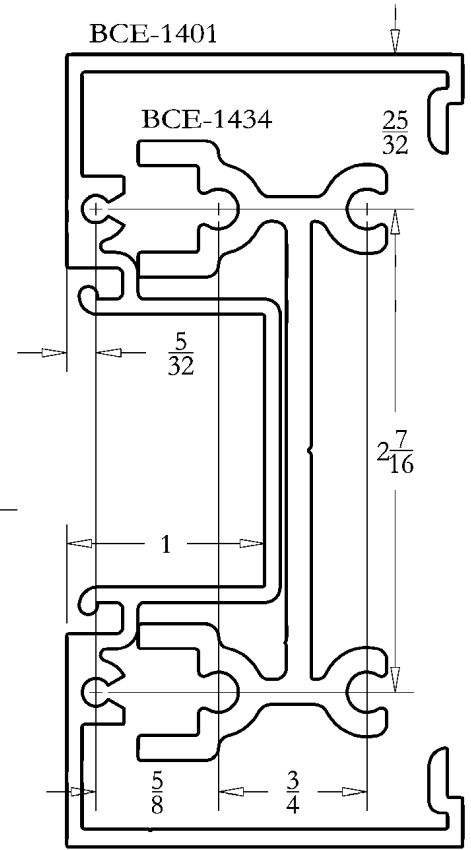
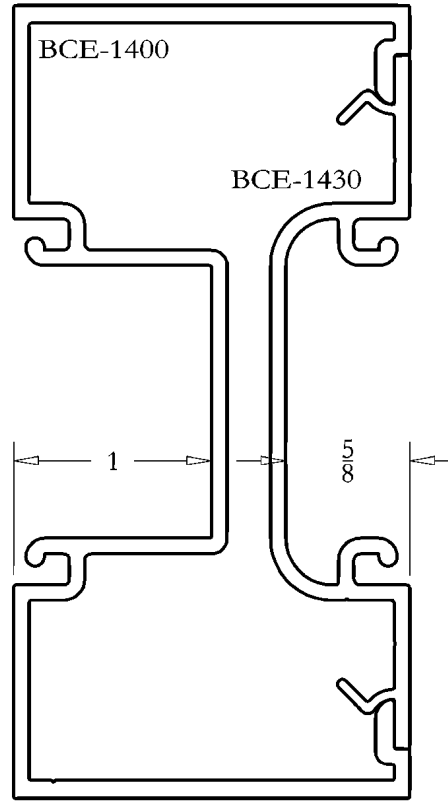
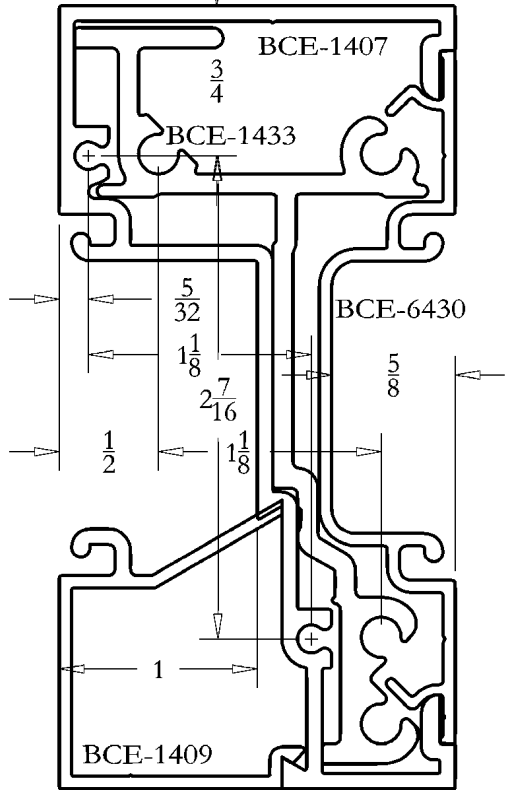

DETAIL SHEET  
2" X 4" FLUSH GLAZED  
BCE-1400



FULL SIZE DETAILS

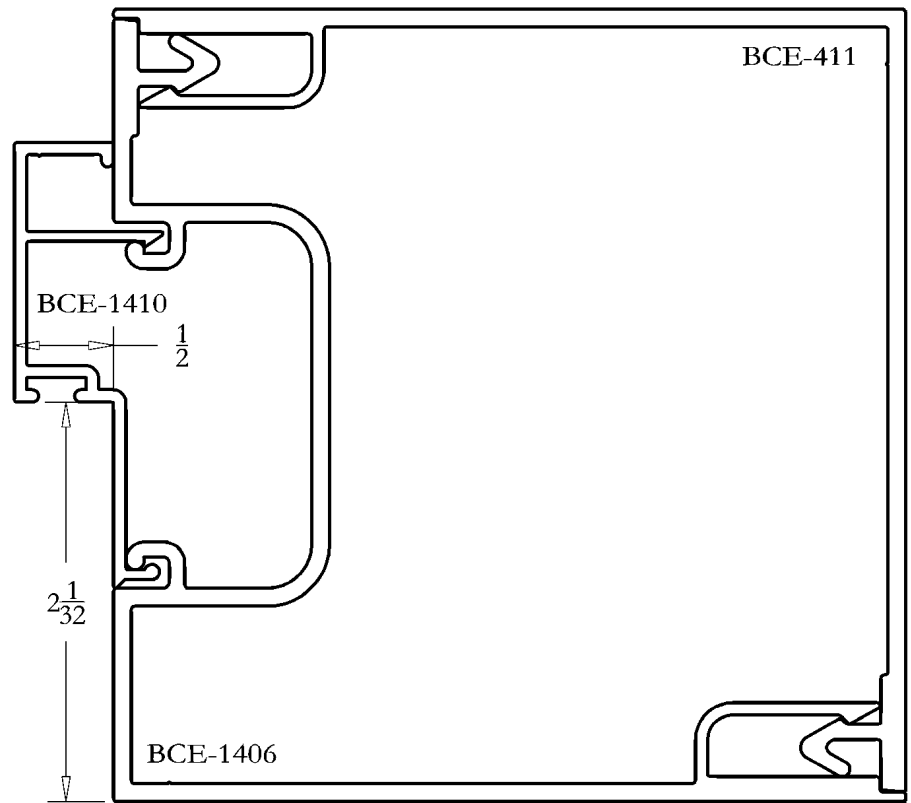
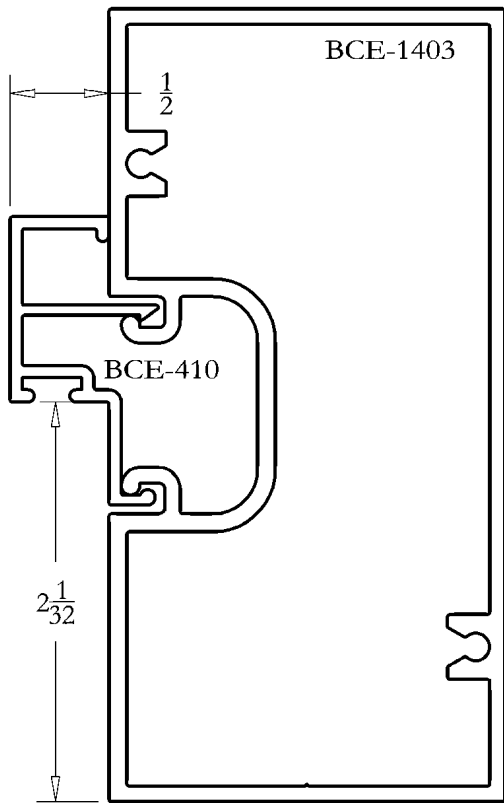

2

4

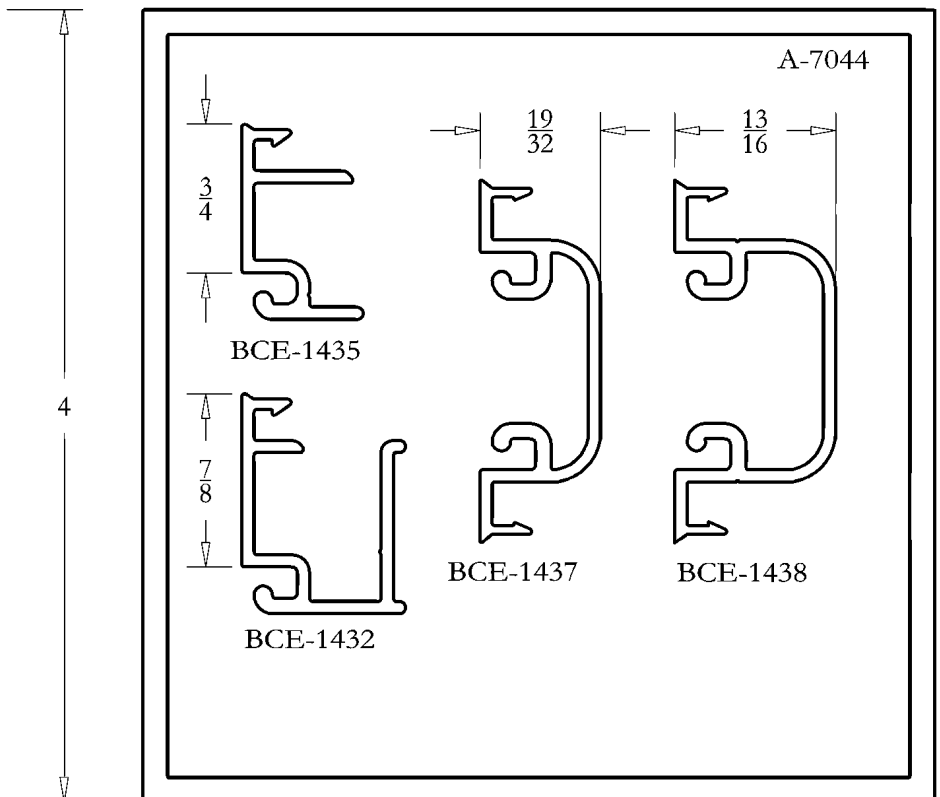
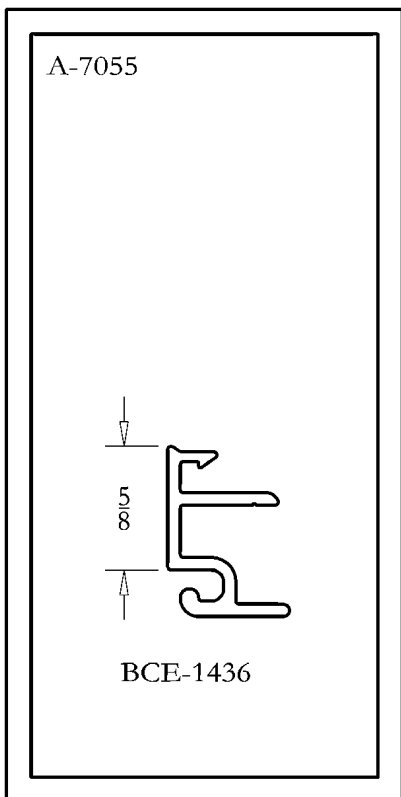

4