

1/4 SIZE DETAILS

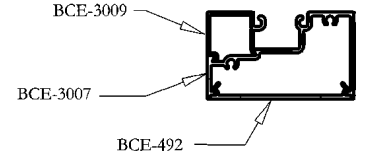
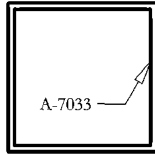
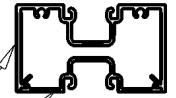
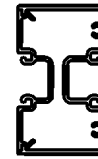
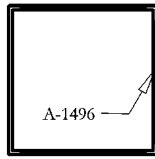

THIS SYSTEM IS DESIGNED TO BE ASSEMBLED WITH #10 SCREWS.

GASKET

REED RUBBER PRODUCTS
 800-325-9698

#3734
 #4893

INTERIOR & EXTERIOR
 INTERIOR & EXTERIOR

UNIVERSAL RUBBER COMPANY
 800-782-2375

#2028

INTERIOR & EXTERIOR

TREMCO
 800-321-6357

TR-2062E

INTERIOR & EXTERIOR

DOOR PILE

SCHLEGEL CORP.
 800-828-6237

AS SELECTED

USED WITH BCE-5

AMESBURY GROUP INC.
 704-878-6892

AS SELECTED

USED WITH BCE-5

NO TEST DATA AVAILABLE
 TREDEGAR EXTRUSIONS INC. DOES NOT MAKE ANY WARRANTY EXPRESS OR IMPLIED INCLUDING
 NO WARRANTY OF MERCHANTABILITY OR FITNESS FOR A PARTICULAR PURPOSE AND RESERVES
 THE RIGHT TO MAKE CHANGES
 REPRODUCTION RIGHTS RESERVED

PRICING FACTORS
1 3/4" x 3" FLUSH GLAZED
BCE-3000 SERIES SERIES



WEIGHT PER FT	EST PER	FACTOR	CAVITY AREA	PART NUMBER	STRUCTURAL VALUES			1/8 SIZE DETAILS
					X-X		Y-Y	
0.896	18.211	20	N/A	BCE3001	0.189	I	0.916	
					0.159	S	0.611	
0.689	14.751	21	N/A	BCE3007	0.137	I	0.643	
					0.136	S	0.379	
0.228	6.576	29	N/A	BCE3009	0.016	I	0.035	
					0.024	S	0.057	
0.431	10.378	24	N/A	BCE3030	0.019	I	0.219	
					0.043	S	0.154	
0.431	10.378	24	N/A	BCE492	0.019	I	0.219	
					0.043	S	0.154	
0.109	2.712	25	N/A	BCE5	0.002	I	0.004	
					0.006	S	0.009	
1.112	9.490	16	N/A	A7026	0.479	I	1.121	
					0.547	S	0.747	
1.350	9.473	13	N/A	A7040	0.566	I	1.338	
					0.647	S	0.892	
1.094	11.973	21	N/A	A1496	1.298	I	1.298	
					0.865	S	0.865	
1.726	11.988	13	N/A	A7033	1.984	I	1.984	
					1.323	S	1.323	
0.775	9.500	24	N/A	A7124	0.345	I	0.799	
					0.394	S	0.533	

FULL SIZE DETAILS

